

Stormdry EP-Board

Product Description

Stormdry EP-Board is an internal insulation plasterboard system for solid walls. Developed using highly insulating slimline aerogel technology, the system enables large energy savings without compromising space.

The board consists of 10 mm of aerogel insulation combined with 3 mm of magnesium oxide board. The boards can be adhered directly to internal walls to increase the energy performance.

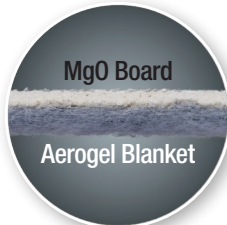

Designed to be used with Stormdry Masonry Protection Cream to boost the natural thermal properties of the wall, the system can significantly increase the energy performance of a property whilst remaining breathable and protecting against moisture ingress. This combined system prevents the effects of interstitial condensation.

Benefits

- Easy to install
- Energy saving
- Space saving – thin insulation for hard to treat walls
- Breathable

Properties

Appearance	Aerogel and MgO board
Thickness	13 mm
Weight	2.775 kg per board
Sizes(s) & Packaging	1.2 × 0.6 m boards
Thermal Conductivity	Aerogel: 0.015 W/mK MgO Board: 0.19 W/mK
Fire Resistance	Aerogel: Class C s1, d0 MgO Board: Class A1
Vapour Resistance	Aerogel: Sd 0.05 m (mu = 5) MgO Board: Sd 0.062 m (mu = 20.7)



U-Value Data

Wall construction	Initial U-Value (W/m²K)	With EP-Board System	Heat Loss Reduction
Solid brick 225 mm	2.1	0.8	61 %

Application Instructions

Preparation

Before any works are carried out, ensure that the substrate is clean, level and suitable for application of the boards. Carry out repairs or make modifications as necessary. Remove any obstacles or fixings that might hinder application such as radiators, switches or sockets.

Application

Lay the **Stormdry EP-Board** on the ground with the dark-grey aerogel blanket facing up. Apply Stormdry EP-Board Adhesive in a continuous line inset approximately 30 mm from the edge of the board until the entire perimeter has been covered. Infill the remainder of the board with the adhesive in a single wide zig-zag pattern.

Pick up the **Stormdry EP-Board**, making sure to grip it at the edges, and offer the adhesive covered side up to the wall. Apply gentle pressure and hold the board in place until the adhesive provides enough adhesion to support itself, making sure that the board is level with the wall. Repeat the process with more boards, tiling them across the wall until the wall is completely covered. They can either be staggered or applied inline.

Cutting Boards

In order to completely cover a wall, it will most likely be necessary to cut some **Stormdry EP-Boards** down to size. Cutting should be carried out outside or in a well-ventilated area with an appropriate dust sheet. Always wear the correct PPE equipment including gloves, goggles and a dust mask. Cutting should be done using either a jigsaw or a mechanical saw. Cuts should always be made from the light grey Magnesium Oxide face of the board.

Where sockets and fixing need to be cut out, drill a hole at each corner and cut out to the correct shape using a jigsaw.

Internal and External Angle Corner Joins

At corners, it is important that the aerogel insulation is allowed to overlap. This prevents a cold bridge at the join between the two boards.

External Angle Corner Joins

For external angle corner joins, one of the boards will need to extend past the edge of the corner by 10 mm. The second board will require the aerogel blanket on the joining side to be cut back 13 mm inset from the edge of the magnesium oxide board. This will allow for the second board to overlap the edge of the first board.

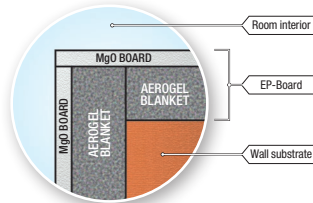

Internal Angle Corner Joins

For internal angle corner joins, one of the boards will require the magnesium oxide board to be cut back 13 mm inset from the edge of the aerogel blanket. To cut whilst retaining the aerogel, cut between board and aerogel to the depth required, e.g. 13 mm, prior to cutting board. The second board will be able to slot in to the gap.

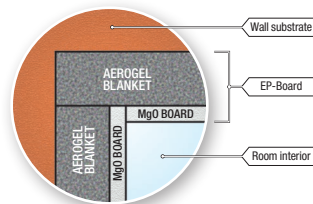

Jointing Panels

Joins between the panels can be filled out using a standard skim tape, jointing compound and sanding techniques. Corner beads should be employed to joint corners.

Decoration

Make sure that the boards are clean and free of dust or debris before applying an even coat of Stormdry EP-Board Primer across the entire boarded wall surface. Once this is dry, the wall will be able to accept standard interior finishes such as paints, plasters and wallpapers.

Subsequent Fixings

For the reinstatement of fixings or the installation of new fixings, such as shelving or appliances, it is important that they are installed through the **Stormdry EP-Boards** and fixed directly to the substrate behind them. The **Stormdry EP-Boards** should not be bearing the load of any fixings.

Other Information

Tested to:

EN12667:2001 Thermal performance of building materials and products

EN13501 BS EN 13501-1:2007+A1:2009

Fire classification of construction products and building elements. Classification using test data from reaction to fire tests.

Information given is in good faith based on experience and usage, however all recommendations are made without warranty or guarantee, since the conditions of use are beyond our control. All goods are sold in accordance with our Conditions of Sale, copies of which are available on request. Customers are advised that products, techniques and codes of practice are under constant review and changes occur without notice; please ensure you have the latest updated information.